

SUPERIOR DEEP CYCLE AGM BATTERY

AMX12-120 (12V120Ah)



CHARACTERISTICS

Item	Specifications	
Voltage	12V	
Dimension	Length	330mm (13.0inches)
	Width	173mm (6.81inches)
	Container Height	213mm (8.39inches)
	Total Height	220mm (8.66inches)
Approx Weight	32.8kg (72.3lbs)	
Terminal	T11(M8)	
Container Material	ABS	
Reserve Capacity	25A	240min
	75A	68min
	20HR	120Ah
Capacity	10HR	114Ah
	5HR	106Ah
	Discharge	-20~55°C (-4~131°F)
Operating Temp. Range	Charge	0~40°C (32~104°F)
	Storage	-15~40°C (5~104°F)

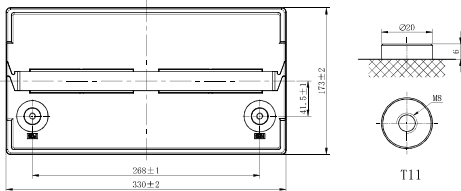
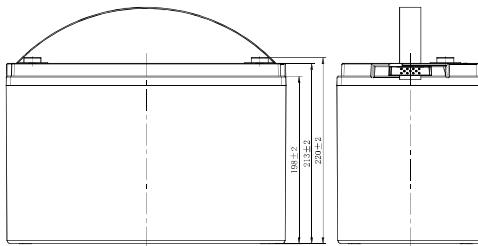

APPLICATIONS

- Electric vehicle
- Golf cart
- Sightseeing
- Cleaning equipment
- AWP
- Mobility



Note: Terminal Torque Values in-lb(Nm):34.39-47.75(3.9-5.4)

SUPERIOR DEEP CYCLE AGM BATTERY

AMX12-120 (12V120Ah)



GENERAL FEATURES

Stable initial capacity

- PAM/NAM amount optimization
- 4BS crystal paste mixing & curing technology
- Double layer separator technology
- Improved design electrolyte S.G.

Less water loss

- PAM/NAM amount optimization
- New PAM/NAM recipe introduced
- Rare earth alloy

Solve NAM sulphation

- Carbon boost technology
- Pre-sulfate technology

Improved PSoC cycling

- Carbon boost technology
- Mix carbon boost technology
- Targeting for higher level through carbon technology

Delay PAM softening and shedding

- Plate assembly pressure re-engineering
- 4BS crystal paste mixing & curing technology
- Higher paste density

Optimize electrolyte stratification

- Introduce AGM-GEL technology

Excellent deep cycle performance

- Plate assembly pressure re-engineering
- New PAM/NAM recipe introduced
- Gel electrolyte technology
- Rare earth alloy
- Double layer separator technology
- Lower acid filling temperature

